

GENERAL NOTE:
 The consultant is not responsible for the accuracy of the survey. Refer to the engineering drawings before proceeding to the work. Report any discrepancies between architectural/engineering drawings to the consultant. General contractor shall check and verify all dimensions and report all errors and omissions to the consultant. Construction must conform to all applicable codes and requirements of authorities having jurisdiction.

NOTE : PROPOSED 5FT. WIDE CONCRETE WALKWAY WILL BE SEPARATED BY CHAIN FENCE FROM THE EXISTING DRIVEWAY AND WILL BE USED FOR WALKWAY PURPOSE ONLY.

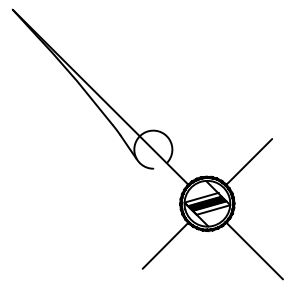

DRENTERS COURT

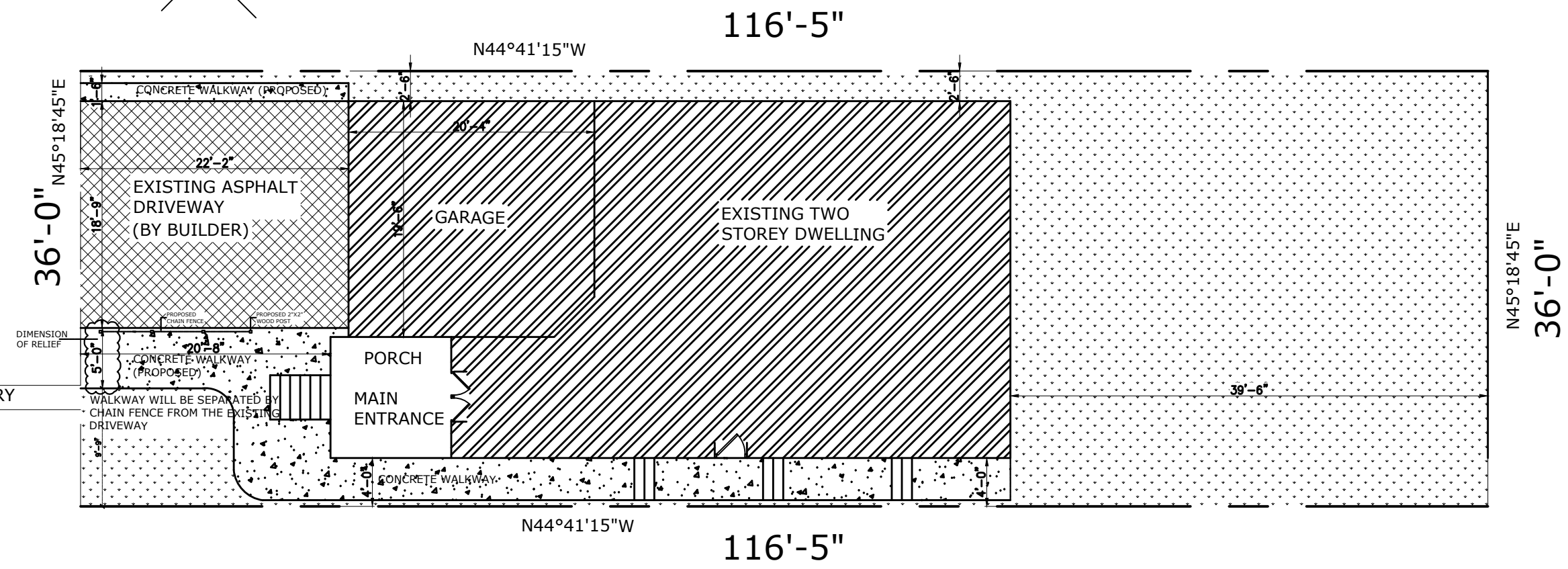

SITE PLAN (CONCEPTUAL)

SCALE: 3/32" = 1'0"

ALL DIMENSION ARE IN FEET-INCHES

DATE:	NO.	DESCRIPTION	BY

REVISIONS:

PROJECT:
DRIVE WAY ENTRANCE

105 DRENTERS COURT
 GUELPH/ERAMOSIA, ON

CLIENT:
SUKHVINDER BASRA

105 DRENTERS COURT
 GUELPH/ERAMOSIA, ON

CONSULTANT:
EXCEL ENGINEERING INC.

4000 STEELES AVENUE WEST
 UNIT 202
 WOODBRIDGE, ON
 CELL: 647-270-5656
 KRISHNA@EXCELENG.CA

DRAWING TITLE:
CONCEPTUAL SITE PLAN

DESIGN: KS	SCALE: AS SHOWN	DRAWING NO: A 1
DRAWN: DBP	DATE: APRIL 2022	
CHECKED: KS	PROJECT NO: 2259	